

Transfusion Stands

Instructions for Use

Code 25420 - Transfusion Stand 5-Star Base 4 Hook

Code 25440 - Transfusion Stand Ward Environment 5-Star Base 4 Hook



1. Introduction

These instructions are intended to assist you with the use and maintenance of the transfusion stand. It is important that these instructions are read thoroughly before using the equipment. The device will be adversely affected and its life expectancy reduced if the following instructions are not observed.

NOTE: If the transfusion stand is damaged or faulty it **must** be taken out of use with immediate effect and the fault reported to Anetic Aid, your authorised dealer or maintenance department. The transfusion stand **must not** be used until the damage or fault has been repaired.

1.1. Warnings & Cautions

Various warnings and cautions are made throughout these operating instructions.



A **WARNING** is given when the personal safety of the patient or user may be affected and when disregarding this information could result in injury.



A **CAUTION** is given when special instructions must be followed. Disregarding this information could result in permanent damage being caused to the trolley.

1.2. Intended Use & Contraindications

Transfusion stands are lightweight, mobile and height adjustable stands intended to support infusion bags for the supply of fluids to patients in a hospital environment.

CONTRAINDICATIONS:

- The transfusion stand should not be used as a walking aid.
 - The transfusion stand should not be used to carry, or support, anything other than infusion bags.
 - The transfusion stand should not be used outside; it may be damaged by pushing it across rough or uneven ground.
-

1.3. Device Classification

The device referenced in this document is CE marked and has been classified as a Class 1 Medical Device under the scope of both the Medical Devices Directive 93/42/EEC and the Medical Device Regulation 2017/745.



EU-UK Authorised Representative Ltd.
Unit 591, Moat House, 54 Bloomfield Avenue,
Belfast, BT5 5AD, Northern Ireland



OZG OneZurich Group Ltd.,
Mülibodenstrasse 3, 8172 Niederglatt ZH,
Switzerland

1.4. Putting the Transfusion Stand into Service

It is important that the transfusion stand is assembled correctly, working properly, and cleaned and disinfected before it is put into service. Use this manual to check all the functions and refer to the 'Assembly' and 'Cleaning and Disinfecting' instructions.

2. Part Identification and Product Specifications

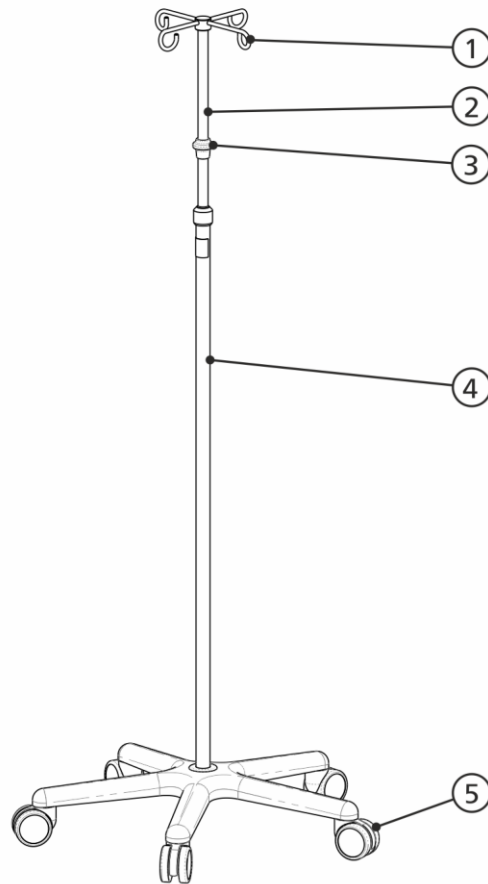

Key;

1. Mounting hook
2. Height adjustable pole
3. Height adjustment lock mechanism;
Code 25420; Lift to release lock
Code 25440; Thumb screw lock
4. Outer sleeve
5. Non-braking castor

Product Specifications		5-Star Base	Ward Environment 5-Star Base
		Code 25420	Code 25440
A.	Min. height	1505mm	1280mm
B.	Max. height	2185mm	2110mm
C.	Product weight	5kg	3.5kg
D.	Max. weight per hook	3kg	1kg
E.	Safe working load*	12kg	4kg

***NOTE:** The safe working load is the total allowable weight for the transfusion pole. For example, the '5-Star Base' safe working load is 12kg. Therefore, if an ancillary device weighing 6kg is attached to the outer sleeve then only an additional 6kg of weight may be suspended from the hooks, i.e., 2 x 3L infusion bags, or 3 x 2L.



WARNING: Failure to observe the correct weight limits could cause instability or failure of the product and result in injury to the user.

Component Material Specification:	
5-Star Base	Teflon® coated finish which is ultra clean and wear resistant
Ward Environment 5-Star Base	Polypropylene
Pole	Bright polished stainless steel
Castors	Ø65mm Polyurethane tyred non-corrosive castors

3. Adjusting the Hook Height

Code 25420: To adjust the height of the hooks, grasp the height adjustable pole firmly, just below the locking mechanism and, using your thumb, lift the mechanism to release the lock. When the desired height is achieved release the mechanism with your thumb to once again lock the pole in position.

Code 25440: To adjust the height of the hooks, grasp the height adjustable pole firmly and unscrew the thumb lock to release the lock. When the desired height is achieved retighten the thumb lock to lock the pole in position.



WARNING: Always ensure the pole is firmly held when released to avoid an uncontrolled decent.

4. Manoeuvring and Handling

Both stand types are fitted with 5 non braking castors, which are suitable for indoor use only.



WARNING: Extra care should be taken when traversing uneven floors, ramps, lift or door thresholds and stray power cables, as the stand may become unstable and topple over. Failure to do so could result in injury to the user.



WARNING: Care must be taken not to leave the stand unattended on a gradient.

5. Cleaning and Disinfecting

It is recommended that only CE marked cleaning products are used in the cleaning of this device. Cleaning and disinfection should be carried out by hand only.

Clean the device with warm water and neutral detergent and dry the surfaces thoroughly using a soft cloth. Suitable disinfectants are: quaternary ammonium compounds, isopropyl alcohol & chlorine bleach up to 1% (10,000 ppm). Apply disinfectant by cloth, spray or disinfectant wipe. Following disinfection, wash all surfaces with clean warm water and dry thoroughly using a soft cloth.

The product will be adversely affected and its life expectancy reduced if the following cautions are not observed;

CAUTION:



- Do not steam clean or jet wash any area of this device.
 - Do not soak or immerse the device.
 - Do not use concentrated bleaching disinfectant solutions, organic solvent or abrasive powders in the cleaning or disinfection of this product.
 - Dilute all disinfectants in accordance with the manufacturer's guidelines.
 - Disinfectant products are corrosive in nature; failure to properly wash and dry the product surface could leave a corrosive residue which may cause damage to the product.
-

6. Product Maintenance

The transfusion stands do not require servicing. However, before use, visually inspect the stand for any loose or damaged parts and foreign bodies caught in the castors. Every six months we recommend the stand is inspected by a competent person, i.e., an Anetic Aid service engineer, to ensure that it is safe to use; contact Anetic Aid for further details.

NOTE: If the stand is damaged or faulty it **must** be taken out of use with immediate effect and the fault reported to Anetic Aid, your authorised dealer or maintenance department. The trolley **must not** be used until the damage or fault has been repaired.



CAUTION: In line with the MHRA Device Bulletin DB2006(5), maintenance work should only be conducted by suitably trained personnel following manufacturer's guidelines.

7. Product Warranty

The product, when new, is guaranteed to be free from defects in materials and workmanship and to perform in accordance with the manufacturer's specification for a period of five years from the date of purchase from Anetic Aid Ltd or their approved Distributor. Anetic Aid Ltd will repair or replace, at their discretion, any components found to be defective or at variance with the manufacturer's specification within this time at no cost to the purchaser. The warranty will take effect from the date of purchase, subject to the purchaser registering the product with Anetic Aid to confirm its receipt, installation date and product details.

The warranty does not provide cover for breakage or failure due to tampering, misuse, neglect, accidents, modifications or shipping. The warranty is also void if the product is not used in accordance with the manufacturer's instructions or is repaired during the warranty period by any persons other than Anetic Aid or its appointed agent. No other expressed or implied warranty is given.

For details of our extended warranty packages please contact Anetic Aid or your authorised dealer.

8. Assembly Instructions

Code 25420: The tapered plug (1) is designed to provide an interference fit into the 5-star base. However, to ensure a solid fit, a cyanoacrylate instant adhesive gel* is used to bond the tapered plug into the base. Apply the full 1g tube into the female taper of the 5-star base as a continuous circular bead, approximately 5mm below the top edge (2). Then, insert the pole with tapered plug (1) into the base, and press down firmly. Finally, attach the hook assembly (3) to the pole.

Code 25440: Insert the castors (5) into the 5-star base. Using the Allen key provided (4), assemble the pole into the base before attaching the hook assembly (3) to the pole.

NOTE: Allow the adhesives 20 minutes to set before handling or using the transfusion stands. Full mechanical strength is achieved after 24 hours curing at room temperature.



* **WARNING:** The glue provided contains ethyl2-cyanoacrylate and should be used with caution. It can cause skin irritation, serious eye irritation, respiratory irritation and can bond skin in seconds. Keep out of reach of children. Avoid breathing vapours.

- Apply the glue in a well ventilated area.
 - IF IN THE EYES: Rinse cautiously with water for several minutes.
 - IF ON THE SKIN: Wash with plenty of soap and water.
-

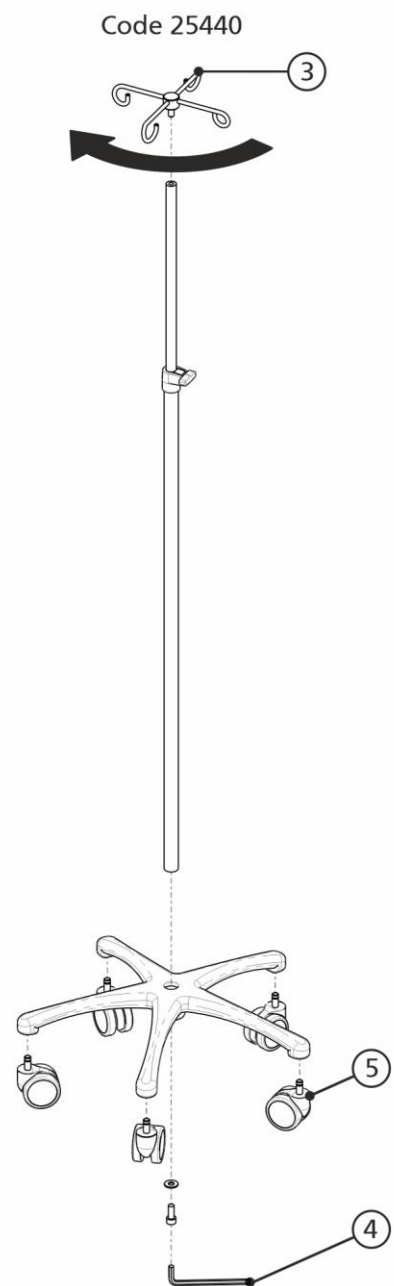
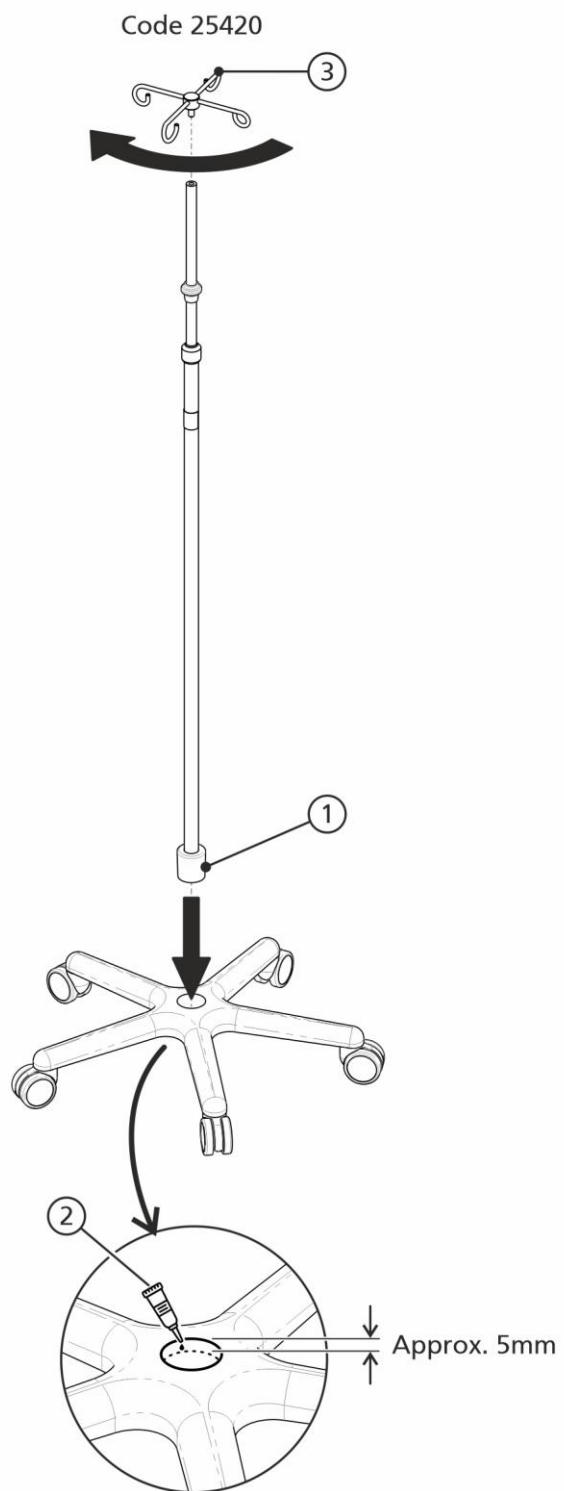



EU-UK Authorised Representative Ltd.
Unit 591, Moat House, 54 Bloomfield Avenue,
Belfast, BT5 5AD, Northern Ireland



OZG OneZurich Group Ltd.,
Mülibodenstrasse 3, 8172 Niederglatt ZH,
Switzerland

For more information on any of our products or service contracts, call:

sales@aneticaid.com **+44 (0)1943 878647** aneticaid.com



DESIGN & INNOVATION



MADE IN THE UK



GLOBAL DISTRIBUTION

Innovative **Medical** Technology - **Practically Applied**



Anetic Aid Ltd., 44 New Lane, Havant, PO9 2NF, UK

Document No. 992030. Issue 13

